

iPads at Langley Grammar

Parents' Briefing
March 2019



Distinguished School

Advancing technology

- Increasing computing power
- Mobile connectivity
- Access to information
 - What did we do before Google?
- Transformation of social and work life

“In times of change learners inherit the earth, while the learned find themselves beautifully equipped to deal with a world that no longer exists.” – Eric Hoffer

Technology in education

What was it like for us at school?

The last few years.....

- Increased use of fixed PCs
- Introduction of laptops
- Wireless networks
- Interactive whiteboards
- Technical 'challenges'.....!

And now.....

- Tablet technology



Expectations

- Businesses expect digital literacy.
- Use of individual devices for learning is increasingly common in universities.
- Students need to be aware of their digital footprint – expectation of independence and trust.

*LGS students need to be
ahead*



**in order to
solve problems
we don't even know
are problems yet.**



The dangers of prediction....

- "This 'telephone' has too many shortcomings to be seriously considered as a means of communication. The device is inherently of no value to us."
 - Western Union internal memo, 1876.
- "Who the h**l wants to hear actors talk?"
 - H. M. Warner (1881-1958), founder of Warner Brothers, in 1927
- "The aeroplane will never fly."
 - Lord Haldane, Minister of War, Britain, 1907
- "We don't like their sound, and guitar music is on the way out."
 - Decca Recording Co. rejecting the Beatles, 1962

The future is.....

- "I think there is a world market for maybe five computers."
 - Thomas Watson (1874-1956), Chairman of IBM, 1943
- "There is no reason anyone would want a computer in their home."
 - Ken Olson, president, chairman and founder of Digital Equipment Corp., 1977
- "640K ought to be enough for anybody"
 - Bill Gates (1955-), in 1981

A close-up, slightly blurred photograph of a person's hand holding a tablet. The tablet screen shows a group of four people, likely students, dressed in winter clothing like snow jackets and hats, standing in a snowy environment. In the background, other people are visible but out of focus. The overall scene suggests a classroom or educational setting where digital technology is being used.

The reality.....

- There are compelling reasons to use 1:1 digital technology to support learning.
- Budget pressures mean we cannot afford to fund individual devices ourselves.
- Parental engagement and support is the only way forward.

A photograph of two students in a science laboratory. They are wearing white lab coats and safety goggles. The male student on the left is holding a blue tablet, and the female student on the right is holding a grey folder. They are both looking at the tablet. In the background, there are bulletin boards with various papers and a red prohibition sign. Another student is visible in the background on the right.

Our students'
perspective

A Teaching Perspective



Research



Blended Learning



Flexibility



C3PdeO

Langley Grammar wants to use iPads to

- Create **C**hallenge
- By challenging students to **C**reate
- So they learn to be '**C**orporate'
(ready for the business world)





It's about creating
something new
to communicate what you know

A photograph of several young women in a classroom, wearing green school blazers. They are looking towards the right side of the frame. One student in the foreground is holding a tablet. The background is slightly blurred, showing other students and classroom elements.

It's about creating
something new
to communicate what you know

A photograph of several young women in a classroom, wearing green school blazers. They are looking towards the right side of the frame. The woman in the foreground has her hair in two braids. The woman next to her is holding a tablet. The background is slightly blurred, showing other students and classroom elements.

It's about creating
something new
**to communicate what
you (they?) know**

Why the iPad?

| Practicality | Functionality | Learning Potential |
|--------------------------|------------------------------|----------------------------|
| Cost effective | Mobile | Vast array of apps |
| Virus free | Creative media tools | Subject-specificity |
| Historical compatibility | Collaboration | iTunes U |
| Apple certified Apps | Intuitive | iBooks |
| Robust | Camera and video | AppleTV |
| 8-10hr battery life | Student response | Mobility |
| | Access to research resources | Seamless ICT incorporation |



Apple Teacher

Unlock the magic of Apple products in your classroom.



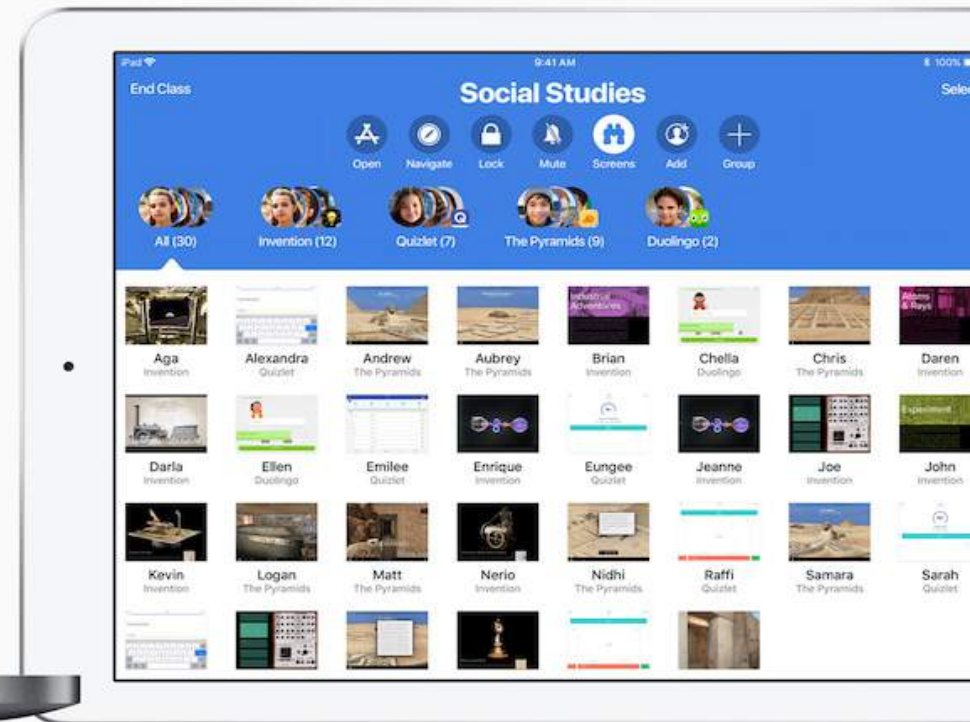

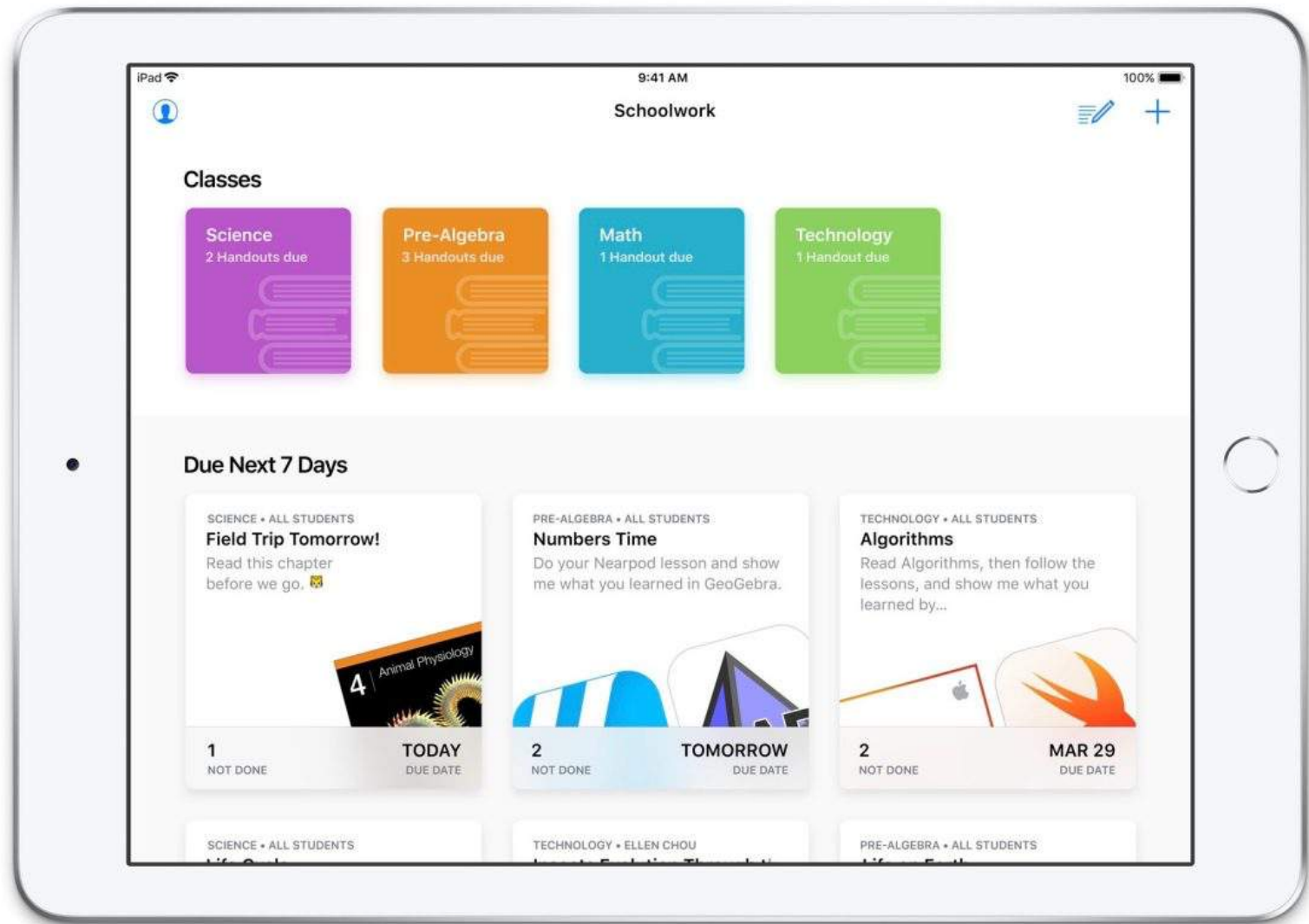

Anti-smoking
videos win
Bucks/Berks
competition

Lego
Programmin
g Regional
Winners

STEAM
project –
stop creation

Apple
Teacher pilot
and
accreditation

Peergrade
and Flipgrid
(media
assessment)

Apple
Classroom

International
Schools
Science
Project

Seesaw /
Swift
Playground
coding (yr 8)

ArcGIS
Survey 123:
first 1:1
school with
FSC

Clips
(Everybody
Can Create)

Race for The
Line (Wind
Tunnel)

Sixth Form –
Explain
Everything

Parenting
Survey

Geogebra
Desmos
'Brilliant'



Flipped
Classrooms
(learning at
home)

Research
about
designers
and artists

Creating
PowerPoints
/ Keynotes

Kahoots /
Headsup /
Socrative

OneNote
(more
accountabilit
y)

Annotating
homework
submission

Online
Textbooks

AppleTV to
present
work /
movies /
iBooks

SIMS
Teacher
(Registers
and
Reports)

iTunesU

Sending
out
resources
quickly /
digitally

Helping to
move
around the
classroom

Animation /
Stopmotion

A Practical Perspective



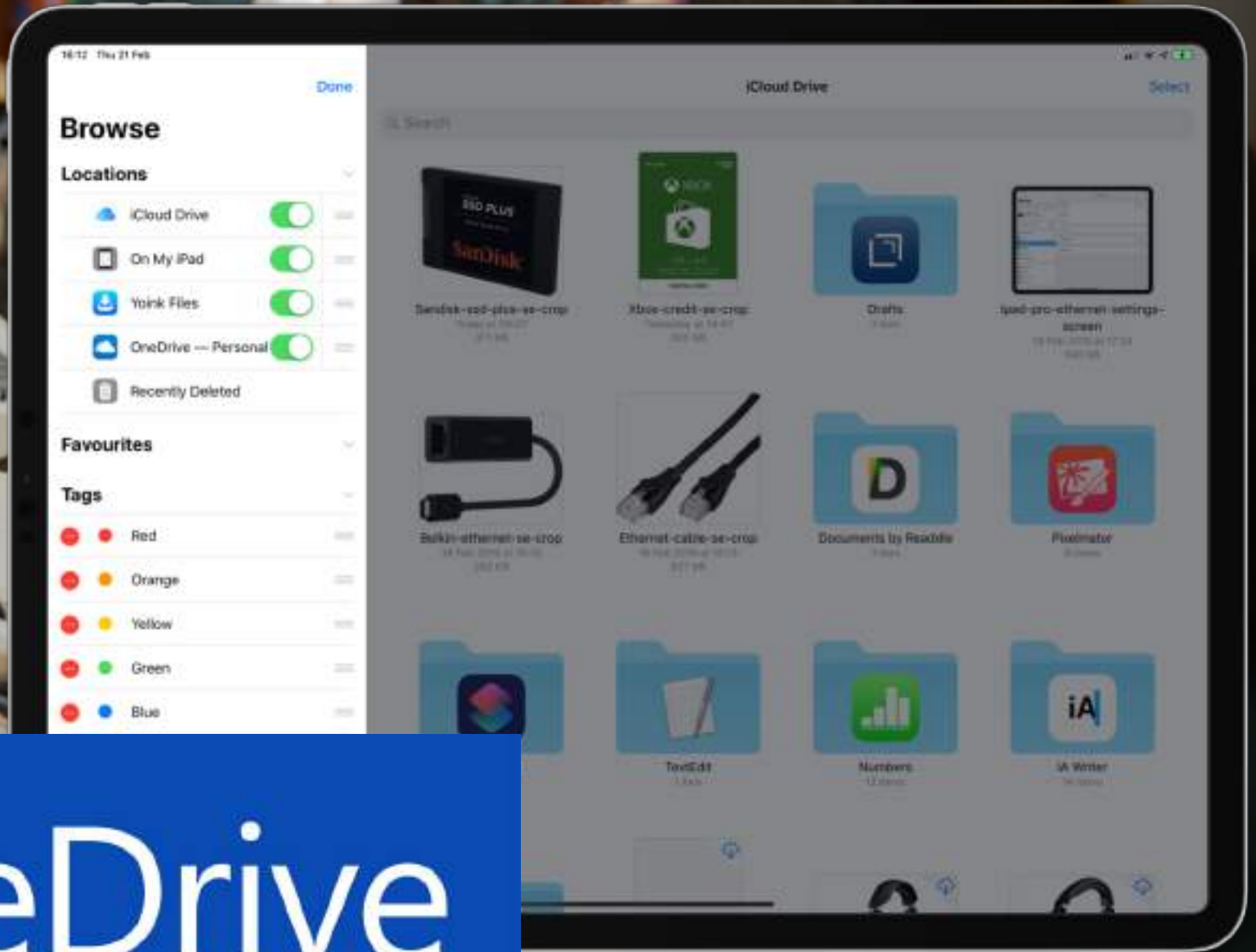

Devices are wiped before being enrolled

Mobile Device Management

- Enrolled onto Jamf MDM
- Device Enrollment Programme (DEP)
- iPads are 'Managed'
- Managed Apple IDs
- Smoothwall Certificates
- SelfService (no AppStore)



Managed ID: danielmace@appleid.lgs.slough.sch.uk

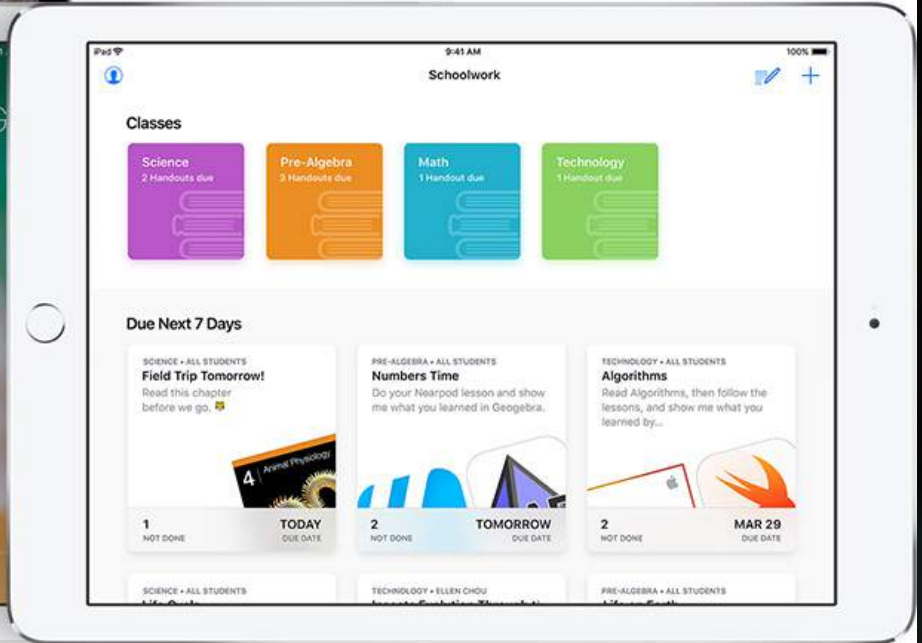

Apple Schools Manager

- Apple Classroom
- Apple Schoolwork

Responsibilities

Morning Journey

- Is it charged?
- Is there enough memory?
- Is it in a case?
- Is it definitely inside your bag?
- Is homework uploaded?
- In the correct format?

Incentives

- L1 – Accidents
- L2 – Repeated, deliberate
- L3/4 – Concerning or dangerous (restricted profile)

Shaping Routes

Each lesson

- First use determined by the teacher
- Necessary apps installed for lessons on that day
- Social media contract

Each subject

- Compatibility is.....
 - Student's responsibility for their work – PDF / Showbie
 - Teacher's responsibility for their work – e.g. Keynote

Rights and Responsibilities

| Around school / PE | Lunch | On the way home |
|---|--|---|
| <ul style="list-style-type: none">• Lock away before PE• Always keep in case provided• Pin-code• No headphones around school | <ul style="list-style-type: none">• Lockers at lunch Leave in Form room (lockers)• Use in library / other designated areas• Care of belongings<ul style="list-style-type: none">• Football• Windows | <ul style="list-style-type: none">• In your bag• Keep in the case• Devices are insured in school / out and abroad if kept in the case |

At home: Rights and Responsibilities



- What restrictions will you place?
- What WiFi filter will you use?
- How will you stop VPNs?
- Do you have a home use policy on your broadband provider?
- Do they have a personal iTunes account under 13?
- Share; don't lock out – open space
- Keep a balance – 'screen time'

ScreenTime

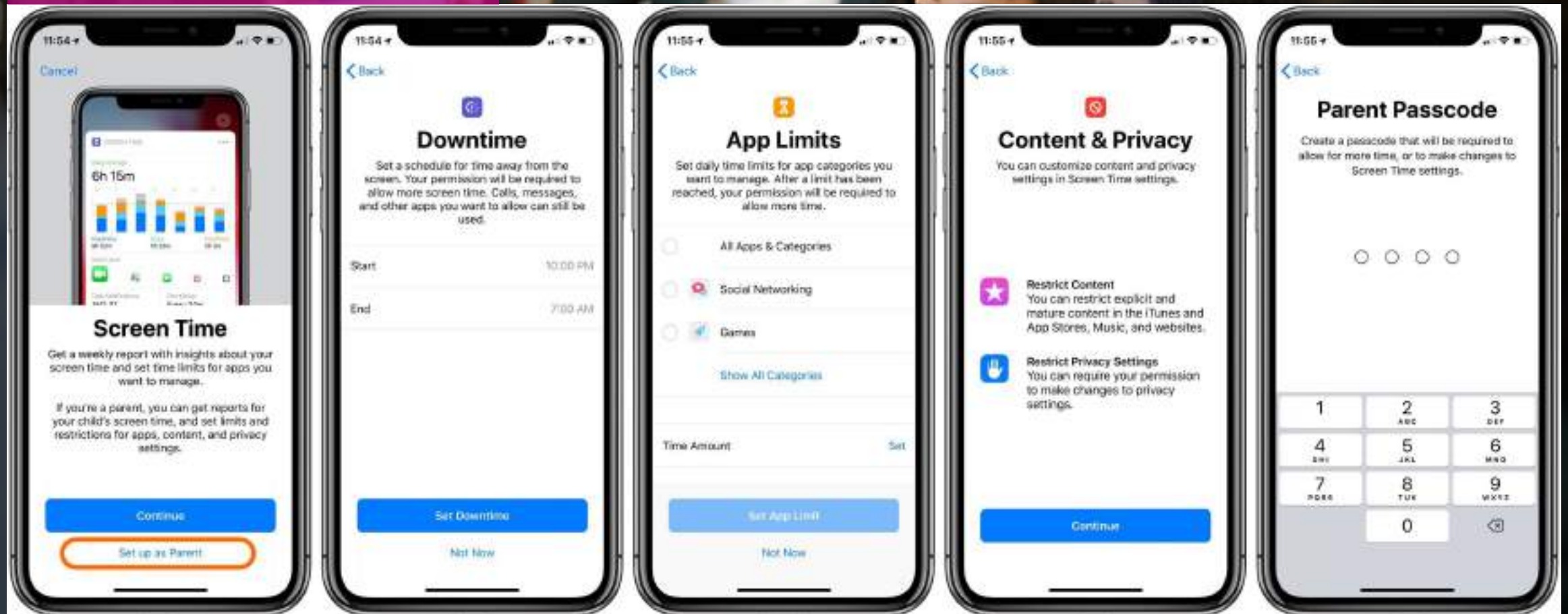

Option 1: Own supply

John Lewis



amazon.com

- Supply an iPad (Air2 onwards)
- Not iPad mini / iPod
- Put it in a case
- We'll wipe for Jamf MDM
- Add MDM, DEP, Restrictions
- Then supply key apps
- Use our wireless

Portal: CPU / CHG / Jigsaw

Langley Grammar School Mobile Device Portal FAQs Terms & Conditions Let's Start Register Log in

JIGSAW

Langley Grammar School Mobile Device Portal



Welcome to our mobile device portal!

We would like to offer you the opportunity to join our Mobile Device Learning scheme at Langley Grammar School. We believe that tablet technology, when used appropriately, can significantly enhance students' learning. iPads can be engaging and exciting to use and can open up new ways of working: they enable students to research, collaborate, create and organise their thinking in ways that would be difficult or even impossible with more traditional methods of teaching.

Option 4: Use an LGS pool iPad

- Use a pool iPad
- (Sign user agreement)
- Collect / return each day
- No excuses re. written work



Timescale

- Apple Launch Event 26th March?
- Portal Opens 1 week after
- Portal Closes 22nd April
- Bring your own iPads c. 29th April?
- iPads arrive Early May
- Setup and Distribution by late May
- Initial training Mid-June
- Use in lessons ICT (June) / September



iPads at Langley Grammar

Parents Briefing

March 2018



Distinguished School



Does Digital Work?

Exercise Books for OneNote

- Permanent record
- Flexible curation of learning journey
- Instant teacher access
- 'On the beach' working

Tests for Socrative

- Short-sharp and effective
- Real-time polling
- Qu by Qu data analysis
- Information returned to students
- Individual reflection

Showbie for HW - personal, trackable

Rainbow Thinking for cards

- Focus on higher-order skills
- Individually and collaboration
- Filming the learning journey

Collaboration

- Shared responses, focus on questioning responses, not gathering

Something new: the Education Reform Summit

- Twitter-planned Face:Face interactions
- Collaborative planning
- Photo streams
- Green screen film making